

LIGHTING FIXTURES
 FI = 4-LAMP F40 BENJAMIN CO-T224-4
 2x4 LAY-IN CLG. MOUNTED OR
 EQUIVALENT
 FZ = WALL MOUNTED INCANDESCENT
 FURNISHED BY OWNER, INSTALLED
 BY CONTRACTOR. SEE DRG. A3

- ROOM SERVICE EQUIPMENT**
- Soiled Dish Shelves 24" x 48" x 74" with epoxy coated 74" posts and 5 shelves.
 - Soiled Dish Table 30" x 10'-0"/5'-0" corner type, radiused horiz. and vert. corners within working surfaces, min. 14 ga. 18-8 stainless steel, 3" rolled edge interior perimeter, 8" high riser along exterior walls, with 20" x 20" pre-rinse sink and basket and scrap block, s.s. tubular legs and cross braces.
 - Pre-rinse sprayer, T. & S. B-113 with B-109 wall basket.
 - Stainless steel overshelf 12" x 5'-0" lg., wall mounted.
 - Waste receptacle under table (by Owner).
 - Dishwasher: Hobart AM14 w/electric tank heat and 4 racks. (5 KW Heater, 1 HP wash motor, 240/60/3 ph.)
 - Booster heater furnished with dishwasher and suspended under table. (Hato custom model, for 40 degree rise, 9 KW, 240/60/3 ph.)
 - Clean Dish Table - same construction as Soiled Dish Table except 30" x 7'-0" lg. with 5' undershelf.
 - Dish Storage Cabinet with base section and wall-mounted upper section, 8'-0" lg. with solid doors, heavy duty laminated construction interior and exterior.
 - New 3 compartment pots/pans coved corner sink, 16 ga. stainless steel with welded integral drainboards, full length backsplash, basket type drains, sanitary rolled rim, stainless steel legs and cross bracing, min. length of 103", 24" L x 21" W drainboards left and right, bowls 16" W x 20" L x 12" D with faucets. Provide Chicago #445-L-15 faucet.
 - Existing 72" x 30" work table with cabinets below, on rollers.
 - New upper cabinets - wall mounted 5'-0" lg. laminated construction, 4'-0" high. Field verify. (2 req'd).
 - Existing Freezer 30" x 30" x 66".
 - Existing Refrigerator 51" x 34" x 80" high.
 - Existing Trash Cart 20" x 16", 32 gal. capacity, (2 req'd).
 - New mobile stainless steel table 24" x 30" with tubular legs, undershelf and casters.
 - Existing 80 gal. gas-fired water heater.
 - Heavy duty restaurant range, gas fired, with range top, 4 burners with replaceable flat griddle, oven heavily insulated, burners and oven porcelain enameled, heavy chrome plated racks with 3 rack positions, one rack per oven, adjustable legs on casters, automatic lighting, positive action thermostats, safety controls and attached pressure regulators for 3/4" gas supply, with flexible connectors, heavy duty commercial with brass quick disconnects, Dormont # 1675-BPQ-B36 inch, stainless steel exterior finish.
 - Heavy duty restaurant range, same as Item 18 except 10 burners and 2 ovens, stainless steel exterior finish.
 - Hood 8'-6" x 4'-0", canopy type, 14 ga. welded black iron with make-up air provisions, including fire safety devices for hood with automatic power cut-offs per NFPA Code and other applicable codes. Work includes 2550 CFM exhaust with mounting curb through roof with 15" x 15" ductwork for exhaust air and 14" x 14" ductwork for make-up air, complete with rainproof screened louver and exhaust head, as indicated on drawings.
 - Existing 45 C.F. Refrigerator with 2 glass doors, 81" x 53".
 - Chef's Table 14'-0" x 5'-0" x 34" high, 14 ga. s.s. top and all stainless construction and with:
 22A 1-18" x 18" chef's sink
 22B 1-16" x 19" x 8" hand sink
 22C 1-19" x 34" x 8" 2-compartment veg. sink
 22D 1-10'-0" x 2'-0" s/s overshelf
 1-14'-0" x 5'-0" s/s undershelf
 3/4 faucets (10)
 3 faucets
 10'-0" pot/pan rack, s.s. table mounted.
 - Microwave oven by Owner.
 - Dish carts - Rubbermaid 18"W x 37-1/2"H x 31"L or Bloomfield #436 stainless steel. (2 req'd).
 - Shelf Section 48" x 24" x 75", shelves Z.P., with 5 shelves.
 - Existing coffee urn stand 48" x 30", s/s top, with 6 coffee urns and cabinet below.

ELECTRICAL SYMBOLS

- CEILING LIGHT OUTLET
- 1 WALL LIGHT OUTLET
- FLUORESCENT LIGHT
- ▨ LIGHT ON EMERGENCY WIRING SYSTEM
- ⊗ EXIT SIGN
- PANEL BOARD
- ⊕ SINGLE POLE SWITCH (3'-4" A.F.F. UNLESS SHOWN)
- ⊕-3 THREE-WAY SWITCH (3'-4" A.F.F. UNLESS SHOWN)
- ⊕-2 DUPLEX RECEPTACLE (1'-0" A.F.F. UNLESS SHOWN)
- ⊕-T TELEPHONE OUTLET WITH 1/2" C. UP TO CEILING SPACE
- E.W.C. ELECTRIC WATER COOLER 115 V. 1 PH.
- ⊕ MOTOR
- ⊕-P SWITCH WITH PILOT
- ⊕-T TELEPHONE TERMINAL CABINET
- FI LIGHTING FIXTURE TAG- SEE SCHEDULE
- ⊕ THERMOSTAT FURNISHED BY HVAC CONTRACTOR
- ⊕-E LIGHT WITH EXHAUST FAN

LOWER FLOOR - REFLECTED CEILING PLAN & ELECTRICAL
 1/4" = 1'-0"

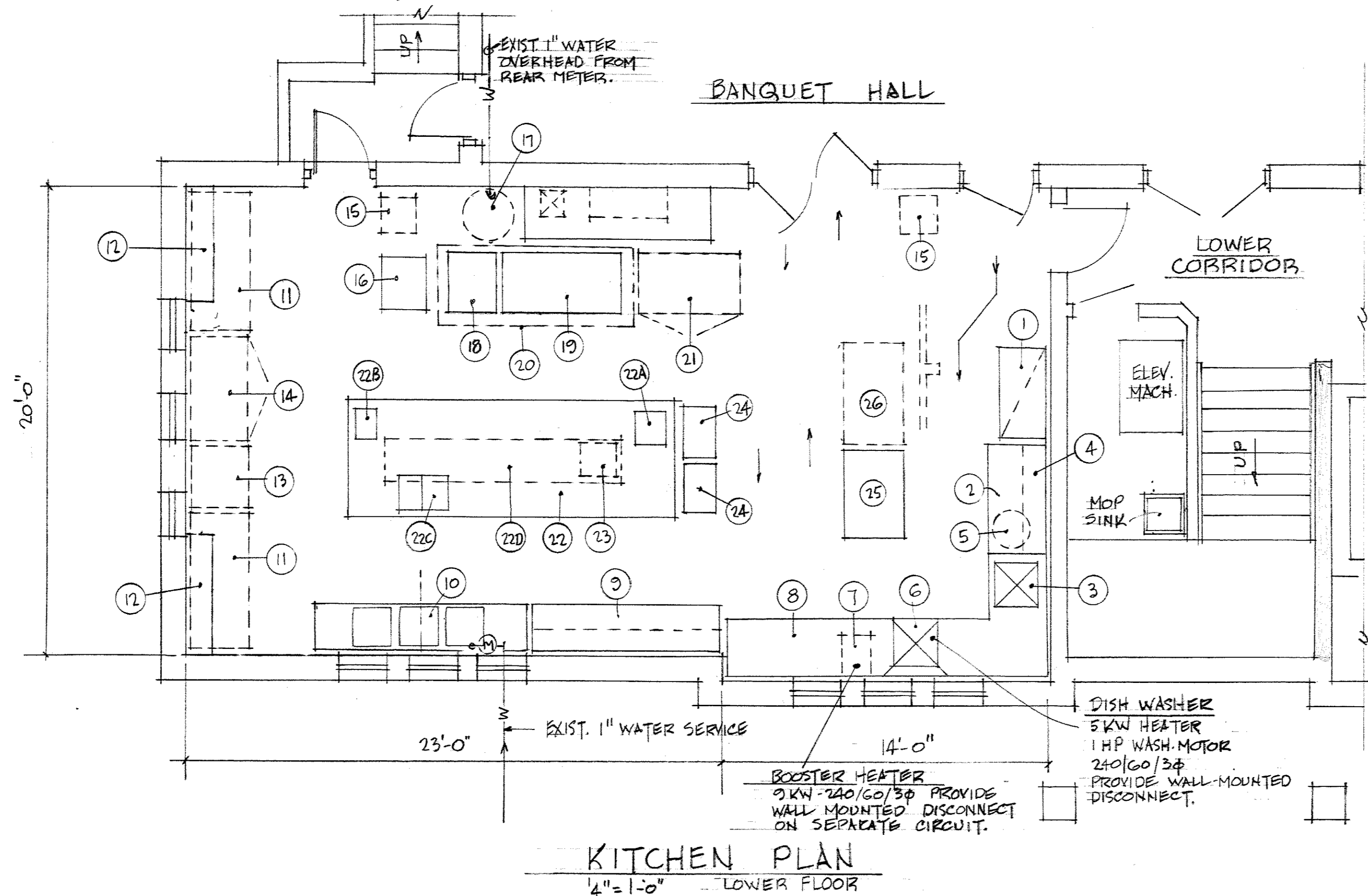

NOTE
 VERIFY ALL VOLTAGES AND FINAL DIMENSIONS BEFORE FABRICATION.

LOWER FLOOR - KITCHEN, REFLECTED CEILING & ELECTRICAL			DES.
ALTERATIONS TO SUGAR GROVE COMMUNITY BUILDING			DR.
141 MAIN ST. SUGAR GROVE, IL 60554			CHKD.
NO.	DATE	DESCRIPTION	DRAWING
REVISIONS			
DATE	JOB NO.		A4
5-22-89	8815		
ROBERT A. WARREN & ASSOCIATES ARCHITECTS & ENGINEERS AURORA ILLINOIS			OF 5